

NHS Entrance and Exit Procedure 2021-2022

Students may only enter and exit according to their classroom location. **See the map on the following page. Your classroom teacher will indicate the exit/stairwell you will use at the end of your class.** Students are reminded to maintain physical distance as they are leaving the classroom/building; to keep their masks on even when they are outside; and that there is no congregating on the front walkway. Students must go directly to their school bus, awaiting vehicle or to start walking home.

Daily Screening Process (initial entry only):

Prior to entering the building each day, students will be screened at their appropriate entrance.

Students may start entering the building at 7:50 am, and should proceed directly to their Block 1 class. The doors will be monitored until **8:15 am**. If a student arrives later than 8:15 am, they must go to the main office to be screened prior to proceeding to their class. If your class is in a portable classroom (P1, P2, etc.) you will go directly to the portable and your classroom teacher will screen students prior to entering.

Process:

- **Step 1:** Secondary students are to complete the York Region, on-line self-assessment [COVID-19 School and Child-Care Screening Tool](#) **prior to entering the school on a daily basis.**
- **Step 2:** Upon completion of the self-assessment tool, complete response to the question: "Have you completed the self-screening test?" in the [Confirmation Form](#).
 - Students will receive an email response when they respond "Yes". The email will include a colour code specific to the day of the week: **MONDAY**, **TUESDAY**, **WEDNESDAY**, **THURSDAY**, **FRIDAY**
 - **Upon entering through the school designated entrances, students will provide confirmation of completion of the self-screening by sharing:**
 - Email or picture of email on phone
 - Hard copy print off of email
 - If neither option is available, they can provide verbal response confirming completion
 - Students who indicate they "did not" complete the self-assessment will be directed to the posted COVID-19 School and Child-Care Screening tool to review the questions and provide verbal response to a staff member
 - if "no" to all, direct to class, or
 - if "yes" to any, direct to the designated isolation room for pickup

West Entrance (Near Theatre)

Rooms: 106, 107, 108, 111, 113, 114, Library, LIB 1, 208, 210, 211, 213, 215, 305, 310, 312, 314

Main Entrance

Rooms: 118C, 137A, 137B, 137G, 218, 221, 301, 302, 303, 304, 316, 317, 319, 322, 326, 327, 328, 329

East Entrance (Near Gyms)

Rooms: 128A, 128B, 130, 135, 223, 224, 227, 228, 231, 233, 333, 334, 336, 337, 339, 340, 345, 346

Portables - (located along the East side of the school)

Rooms - P1, P2, P3, P4, P5, P6, P7, and P8

Newmarket High School

1st

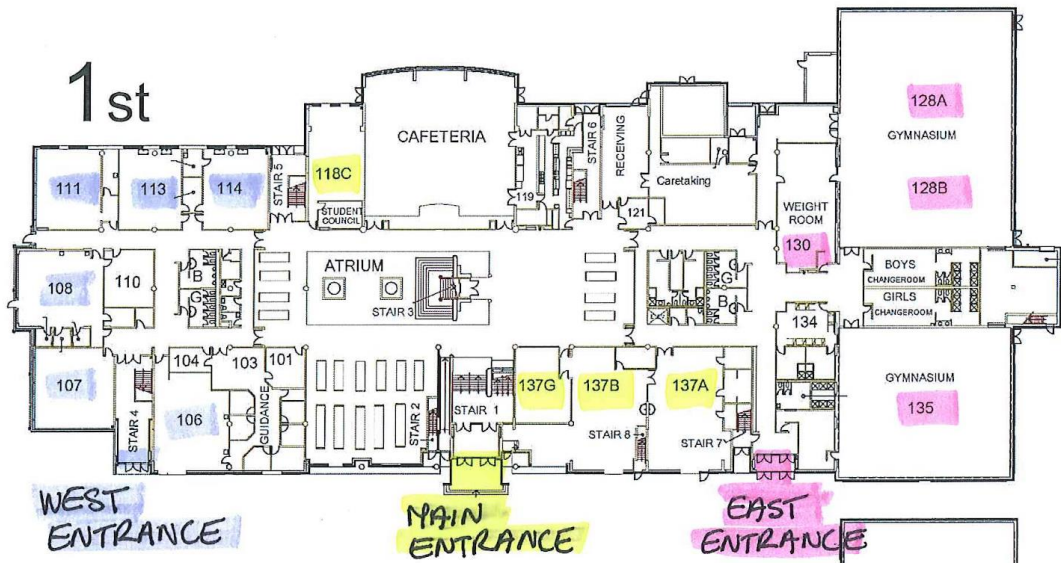

2nd

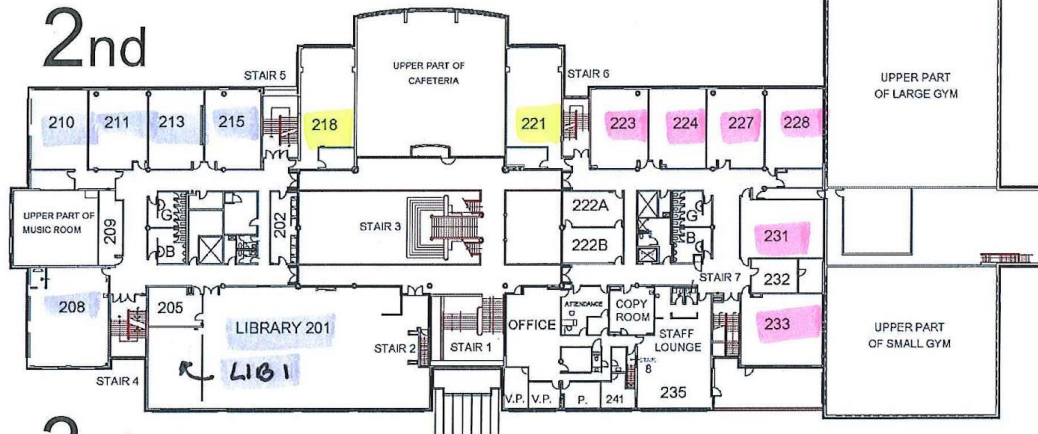

3rd

